

Wirepac® 3dB Quadrature Hybrids

- Drop-in, surface mount and flanged options
- Ready to install
- High power handling capability
- Low loss, low cost
- Aerospace and commercial heritage

Electrical Specification	FA*1 KC*1 LC*1	KC*1 LC*2
	Bandwidth Optimization	Narrow
Coupling, Coupled Path (dB)	3.00 ± 0.15	2.70 ± 0.15
Unbalanced, Max. (dB), Coupled Path to Main Line	0.3	1.1
Insertion Loss Max. (dB)	0.2	0.2
Isolation, Min. (dB)	30	30
Directivity, Min. (dB)	27	27
VSWR, Max.	1.1:1	1.1:1
Power, Average (W)	500	500
Power, Peak (kW)	2.5	2.5
Phase Quadrature Error, Max. (°)	±1	±1
Dielectric Breakdown, Min. (V RMS)	1000	1000

Mechanical Specification	FA*1	KC*1, LC*1 KC*2, LC*2
	Weight ounces (grams) per inch/mm	0.15 (4,3)

* Shield finish code - see Part Number Key on Website Datasheet

Electrical specifications summarized in the table above are determined by measurements at 300 MHz in a matched 50 ohm system and are independent of physical length and frequency with the exception of power. At jacket temperatures above 55°C, the power should be derated linearly to 50% at 105°C and to 0 at 155°C.

FA (Flanged)

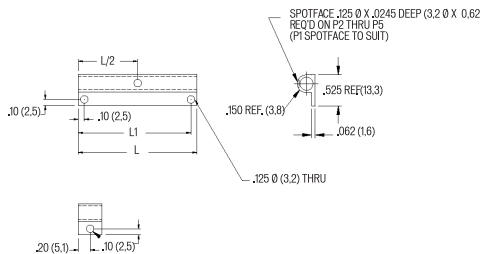

KC (Round), Crossover & Non-Crossover

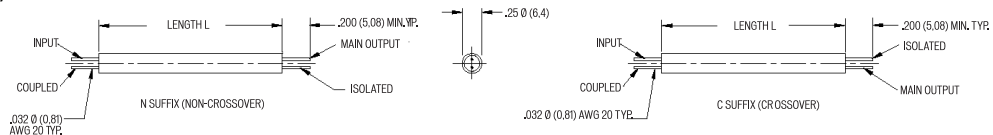

LC (Square), Crossover & Non-Crossover

