

RF/Microwave Amplifier



Features

- Unconditionally Stable
- Wide 5 to 300 MHz Bandwidth
- Environmental Screening Available

Technical Specifications

| Characteristic | TYPICAL Ta = +25 °C | MIN/MAX Ta = -55°C to +85 °C |
|--------------------------|------------------------|---------------------------------|
| Frequency | 5 to 300 MHz | 5 to 300 MHz |
| Gain (dB) | 11 | 9 Min. |
| Gain Flatness (dB) P-P | +/- 0.6 | --- |
| Power @ 1 dB Comp. (dBm) | +22 | +19 Min. |
| Reverse Isolation (dB) | 30 | --- |
| VSWR | In | 1.4:1 |
| | Out | 1.4:1 |
| Noise Figure (dB) | 6.0 | 7.5 Max. |
| Power | Vdc | +15 |
| | mA | 70 |
| | | 75 Max. |

Note: Care should always be taken to effectively ground the case of each unit.
(Packages below are for reference only)

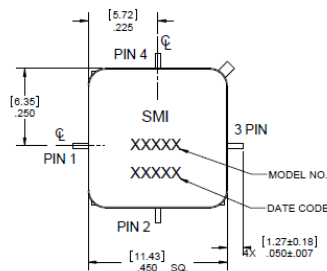
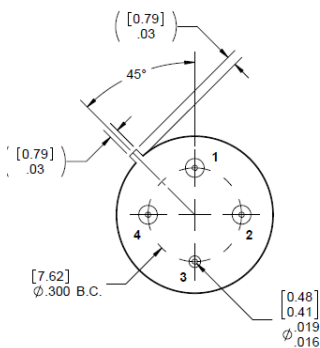

Typical* Intermodulation Performance at 25 °C

| | |
|--|----------------|
| Second Order Harmonic Intercept Point: | +56 dBm (Typ.) |
| Second Order Two Tone Intercept Point: | +52 dBm (Typ.) |
| Third Order Two Tone Intercept Point: | +37 dBm (Typ.) |

*Note: Measured at Midband.

Absolute Maximum (No Damage) Ratings

| | |
|---------------------------|-----------------------------------|
| Operating Temperature | -55°C to +100 °C |
| Storage Temperature | -62°C to +125°C |
| Case Temperature | +125 °C |
| DC Voltage | +18 volts |
| Continuous RF Input Power | +13 dBm |
| Short Term RF Input Power | 200 Milliwatts (1 Minute Max.) |
| Maximum Peak Power | 0.5 Watt (3 µsec Max.) |

| | |
|---|--|
| Grounding Instructions | Care should be taken to effectively ground each unit. |
| Revisions | API reserves the right to make revisions to both product and/or the information contained within their datasheets without advanced notice. |
| Min./Max. Values | Specifications are guaranteed when tested in a 50 Ω (ohm) system. |
| Typical performance graphs and values are measured at 25°C, but not guaranteed. | |