

Available as:

TOM9326, 4 PIN TO-8 (T4)
 TON9326, 4 Pin Surface Mount (SM3)
 BXO9326, Connectorized Housing (H1)

Voltage Controlled Oscillator

Frequency Range: 2255 – 2280 MHz

Features

- Low Tuning Voltage Sensitivity
- Operating Case Temperature 0 °C to + 50 °C
- Screening to the tables of MIL-STD-883 available

Technical Specifications

CHARACTERISTIC	TYPICAL Ta=+25°C	MIN/MAX Ta = 0°C to +50 °C
Frequency	2255 – 2280 MHz	2255 - 2280 MHz
Output Power (dBm)	+6.0	+4.5 Min.
Power Flatness (dBm)	±0.25	±0.5 Max.
Tuning Voltage Range (V)	0.5 to 4.5	0.5 to 4.5
Tuning Voltage Sensitivity (MHz/V)	10.0	7.0 Min.
Harmonics (dBc)	-24	-20 Max.
Spurious (dBc)	<-80	-80 Max.
Phase Noise @ 100 KHz (dBc/Hz)	-110	-100 Max.
Pushing (MHz/V)	6.0	9.0 Max.
Pulling (MHz); 12 dB RL	30.0	40.0 Max.
Frequency Drift (MHz/°C)	0.08	0.17 Max.
Power	Vdc	+5
	mA	18.0

*Typical values are measured at 25°C, but not guaranteed.

Maximum No Damage Ratings

Ambient Operating Temperature	-55°C to + 100 °C
Storage Temperature	-62°C to + 125 °C
Case Temperature	+ 125 °C
DC Voltage	+ 10 Volts
Maximum DC Tuning Voltage	+ 15 Volts
Minimum DC Tuning Voltage	0 Volts

Outline Drawing

MATERIAL:

1. HEADER / LEADS - KOVAR
2. LID - NICKEL
3. FINISH: HEADER / LEADS - GOLD/NICKEL PLATING
LID - NICKEL
4. DIMENSIONS ARE INCHES (mm)

TOLERANCE
.XX ±.02 [.6]
.XXX ±.010 [.25]

AMPLIFIER

PIN 1 - +VDC VOLTAGE
 PIN 2 - 50 OHM INPUT
 PIN 3 - (GROUND) DC & RF
 PIN 4 - 50 OHM OUTPUT

VCO

PIN 1 - +VDC VOLTAGE
 PIN 2 - TUNING VOLTAGE
 PIN 3 - (GROUND) DC & RF
 PIN 4 - 50 OHM OUTPUT

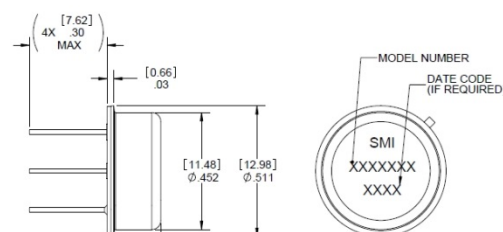
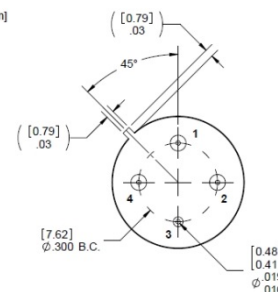

* COMPONENT HEIGHT MAY VARY ACCORDING TO SPECIFIC DEVICE CONSULT SPECTRUM MICROWAVE FOR ADDITIONAL INFORMATION IF REQUIRED

Typical Performance Data

Legend ——— +25 °C - - - - +50 °C - - - - - 0 °C

